

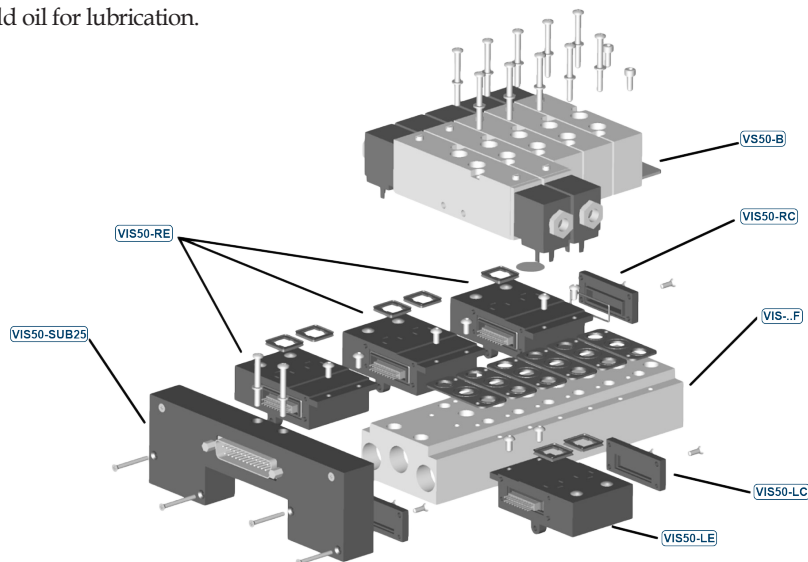

Product feature

1. Valve island with multi pole connector VIS series is a compact valve manifold of G1/8 port size. It is supplied assembled and tested both pneumatically and electrically read to be used by the customer for its need. Main features are: compactness, expanding till maximum 16 places, Leds to show each coil status. VIS valve island can be ordered with blanking plates in order to accept more valves and can be assembled pneumatic operated valves. Sub D 25 pins male connector can be connected to the VIS25.
2. The valve island uses the VS50 series with the features below.
3. - Three position solenoid valves have three kinds of central function for your choice;
 - Double control solenoid valves have memory function;
 - Internal hole adopts special processing technology which has little attrition friction, low start pressure and long service life;
 - No need to add oil for lubrication.



Pressure and feature of flow

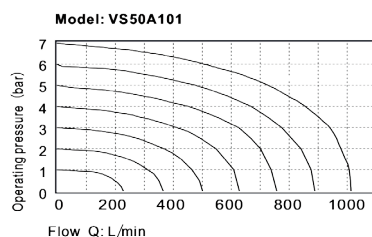

Specification

Valve	VS50A101	VS50A201	VS50B301	VS50B401	VS50B501
Fluid	Air(to be filtered by 40 μm filter element)				
Acting	Internal pilot or external pilot				
Port size	1/8″G				
Valve type	5 port 2 position		5 port 3 position		
Lubrication	Not required				
Operation pressure	1.5~8bar(21~114psi)				
Proof Pressure	15bar(215psi)				
Temperature °C	-20~70°C				
Orifice size ²)	12.0mm²(Cv=0.67)		9.00mm²(Cv=0.50)		
Material of body	Aluminum alloy				

Coil specification

Item	Specification
Standard voltage	DC24V
Scope of voltage	DC: ±10%
Power consumption	DC:2.5W
Protection	IP65
Temperature classification	B Class
Electrical entry	Terminal
Actating time	0.05 sec and below
Max. frequency ①	5 cycle/sec

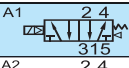
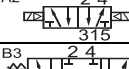
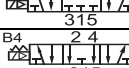
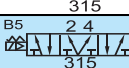
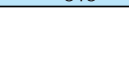
A1	VS50A101-VC		Solenoid valve 5/2 way - single - acting
A2	VS50A201-VC		Solenoid valve 5/2 way - double - acting
B3	VS50A301-VC		Solenoid valve 5/3 way - double - acting closed center
B4	VS50A401-VC		Solenoid valve 5/3 way - double - acting exhaust center
B5	VS50A501-VC		Solenoid valve 5/3 way - double - acting pressure center

Ordering code

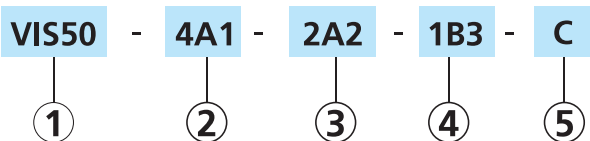

Position 1

Position 2

① Model	-	② Quantity valve	Type valve	-	③ Quantity valve	Type valve
VIS50: Island valve		* 2 ~16 valves	A1: single acting A2: double acting B3: double acting closed center B4: double acting exhaust center B5: double acting pressure center		* 2 ~16 valves	A1: single acting A2: double acting B3: double acting closed center B4: double acting exhaust center B5: double acting pressure center

Position 3

- ④ Quantity valve	Type valve	- ⑤ Blank: No Multiple cable
* 2 ~16 valves	A1: single acting A2: double acting B3: double acting closed center B4: double acting exhaust center B5: double acting pressure center	C: Multipole cable 5 meters

		Single Acting															
Double-Acting		1	2	3	4	5	6	7	8	9	10	11	12	13	14	15	16
	0																
	1																
	2																
	3																
	4																
	5																
	6																
	7																
	8																
	9																
	10																

* Insert the number and code of the valves pay attention on the maximum number of one and double solenoid valves that can be used (see diagram). Maximum number of valve on the island is 16. Voltage is 24V.DC.

Dimensions

VIS1

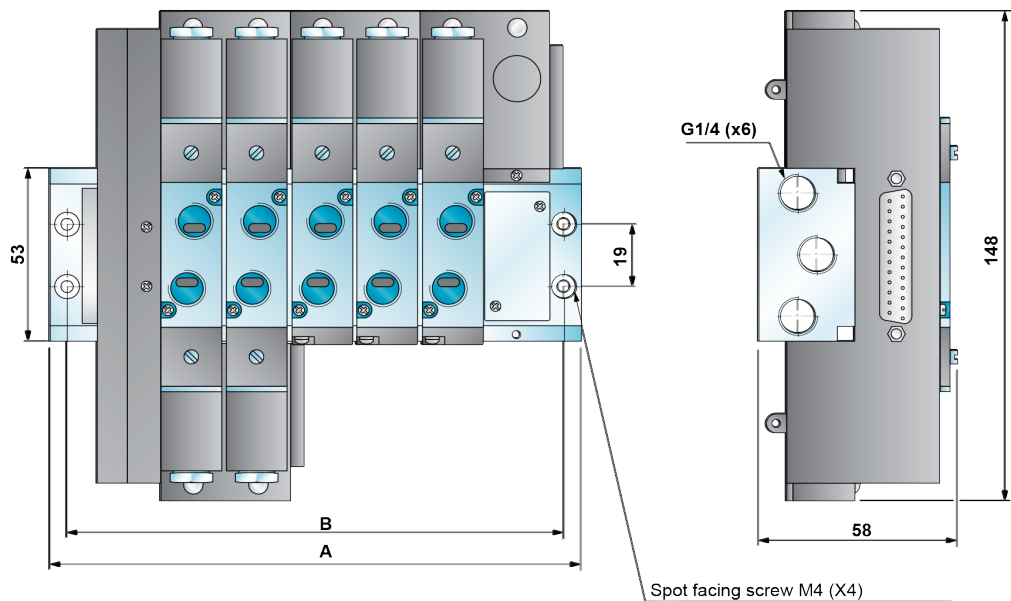

N° places	2	4	6	8	10	12	14	16
A	80	118	156	194	232	270	308	346
B	69	107	145	183	221	259	297	335

VIS2

Connector PIN/Solenoid match

PIN	1	2	3	4	5	6	7	8	9	10	11	12	13	14	15	16	17	18	19	20	21	22	23	24	25		
Coil	1L	2L	3L	4L	5L	6L	7L	8L	9L	10L	11L	12L	13L	10R	14L	9L	15L	14L	16L	7R	6R	5R	4R	3R	2R	1R	COM (-)

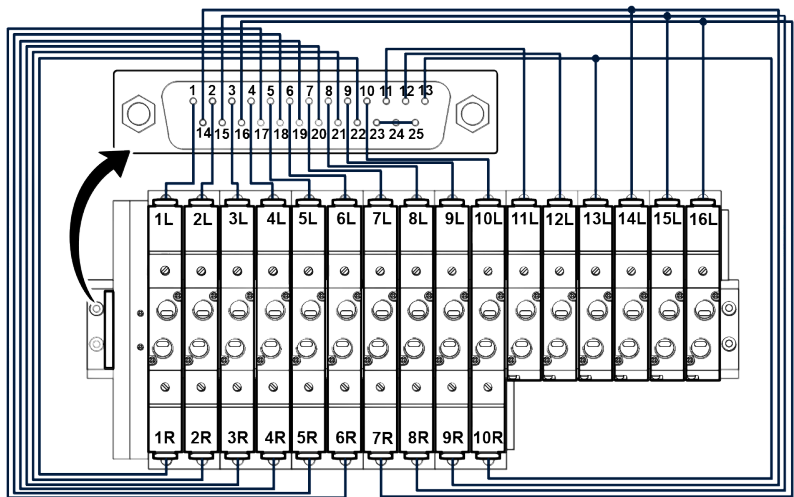

Multipole Cable



Code: VIS25

Cable	PVC Ø mm
Wire	25 wires 0,27 mm² tinned tips
Connector	PBT
Screws	stainless steel
Seals	NBR RUBBER
Protection degree	IP65

PIN	Colour	PIN	Colour
1	Black	14	Brown/White
2	Brown	15	Red/White
3	Red	16	Orange/White
4	Orange	17	Green/White
5	Yellow	18	Blu/White
6	Green	19	Violet/White
7	Blue	20	Red/Black
8	Violet	21	Orange/Black
9	Grey	22	Yellow/Black
10	White	23	Green/Black
11	Pink	24	Grey/Black
12	Light green	25	Pink/Black
13	Black/White		